

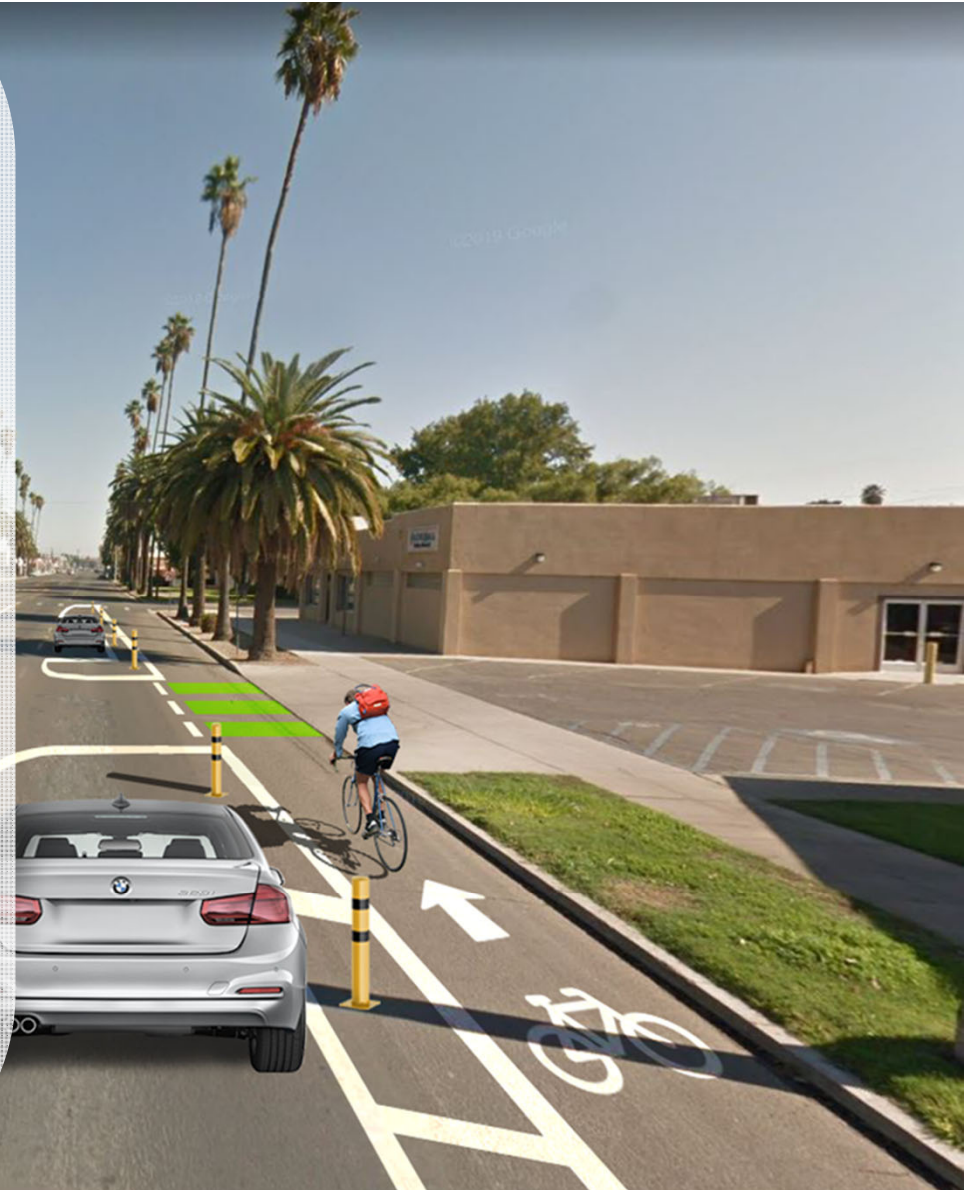

SR 233/Robertson Boulevard Corridor
Planning Study

Stakeholder Advisory Committee Meeting II June 15, 2020



Agenda

Welcome and Instructions	5:00 – 5:15	Kim Anderson/Evelyn Espinosa
Project Update	5:15 – 5:25	Ian Lin
Outreach Update and Findings	5:25 – 5:35	Kim Anderson
Downtown Segment Corridor Concepts Presentation	5:35 – 6:00	Ian Lin
Other Segment Concepts	6:00 – 6:15	Ian Lin
Summary of Input and Next Steps	6:15 – 6:30	All
Additional Q & A	6:30 – 7:00	All



Study Area

SR233/Robertson
Boulevard between
Highway 152 and
Road 19

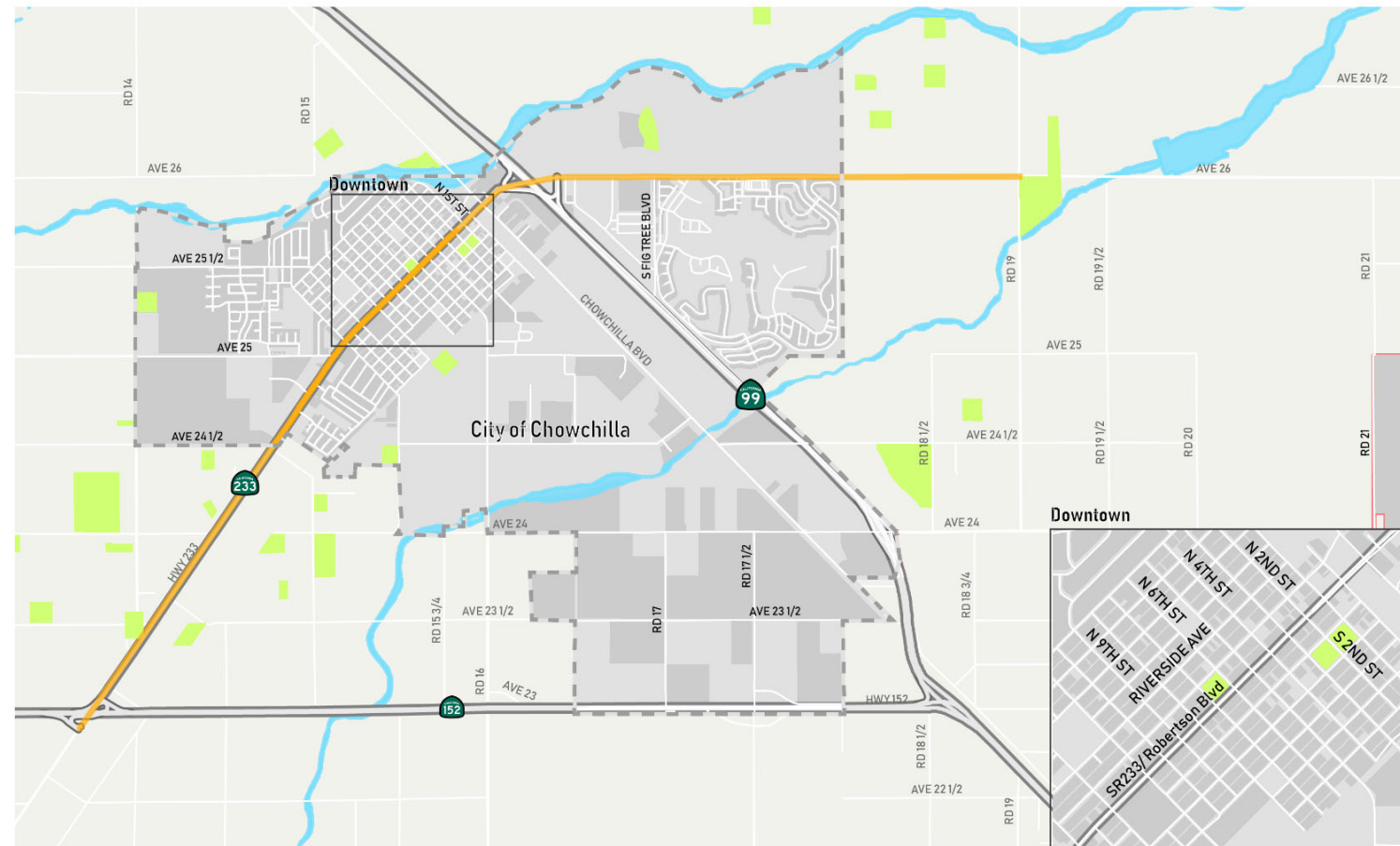

Study Area

Figure 1



 Chowchilla City Boundary
 Study Corridor

Project Updates

- Presented Existing Conditions Report, February 2020
 - MCTC Board Meeting
 - City of Chowchilla Planning Commission Meeting
- Phase One Survey Summary Report, April 2020
- Development of Conceptual Alternatives



Community Outreach

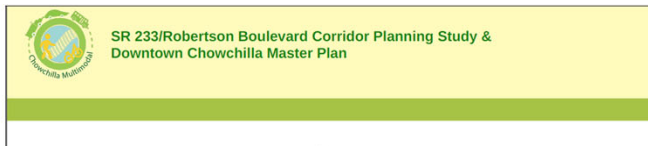

1. Please check the answer that
- ☐ I own a business located on SR 233/Robertson Boulevard
 - ☐ I live on SR 233/Robertson Boulevard
 - ☐ I commute through SR 233/Robertson Boulevard in Chowchilla daily
 - ☐ Other (please specify)

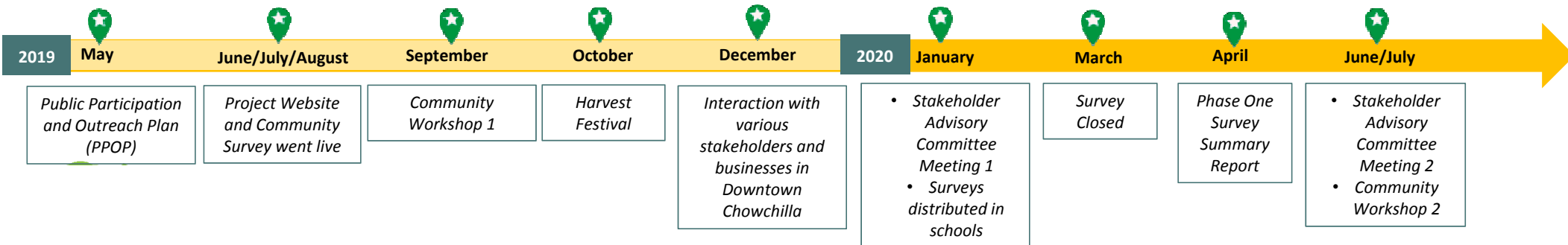
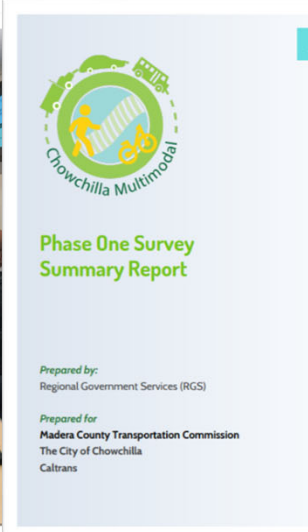

Outreach Findings:

- Enhancing pedestrians and bicyclists safety is the top priority
- On-street parking in Downtown Chowchilla is necessary
- Conceptual alternatives include improvements such as:
 - Continuous sidewalk network
 - Marked crosswalks at intersections
 - ADA curb ramp upgrades
 - Separated Class IV bike lane and buffered Class II bike lane
 - Median islands
 - Bulb-outs





Segment C, Alternative 1: Road Diet and Parking Protected Bikeway

ALTERNATIVE 1 SHOWN BELOW

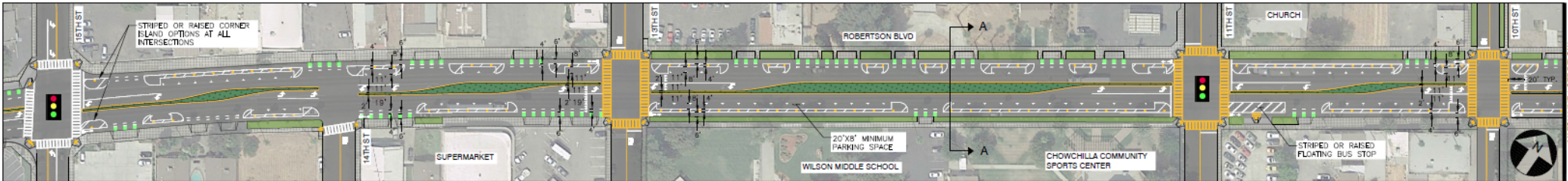

ALTERNATIVE 1 SHOWN BELOW

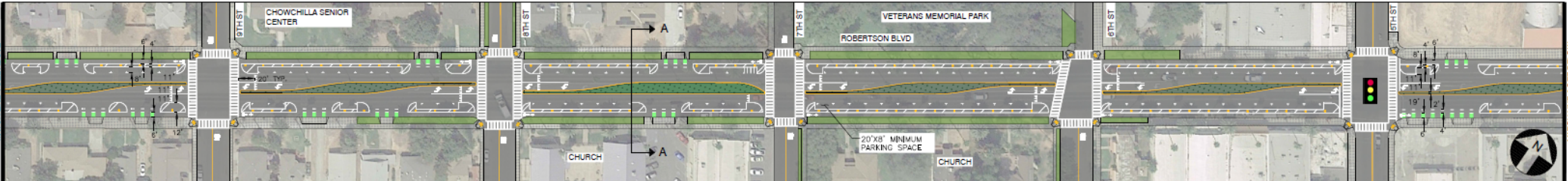

ALTERNATIVE 1 SHOWN BELOW

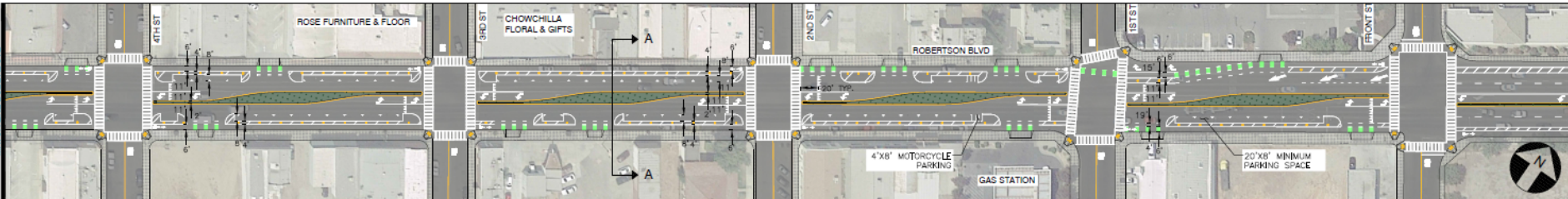

Segment C, Alternative 1: Road Diet and Parking Protected Bikeway

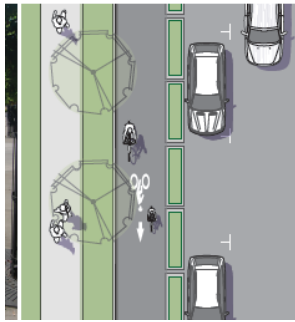
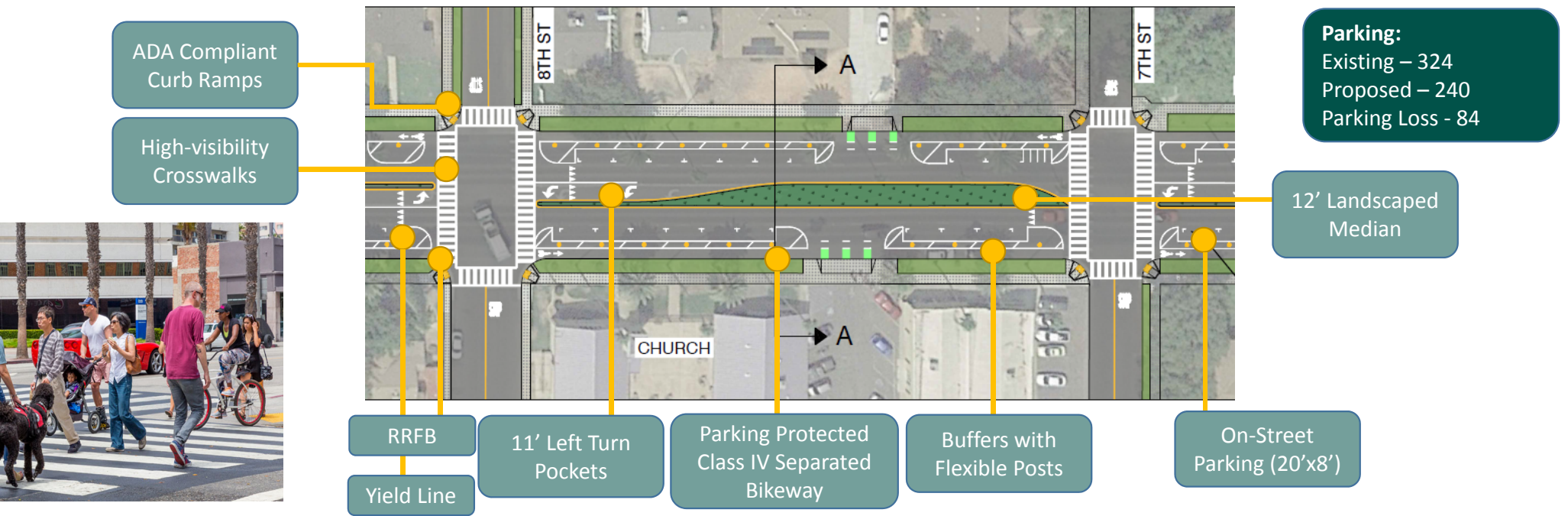

Segment C, Alternative 1: Road Diet and Parking Protected Bikeway

Existing: At Robertson Blvd and 1st St



Alternative 1: At Robertson Blvd and 1st St



EXISTING CROSS SECTION A-A

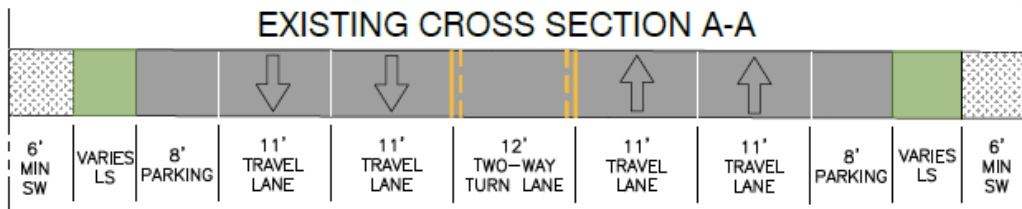

PROPOSED CROSS SECTION A-A

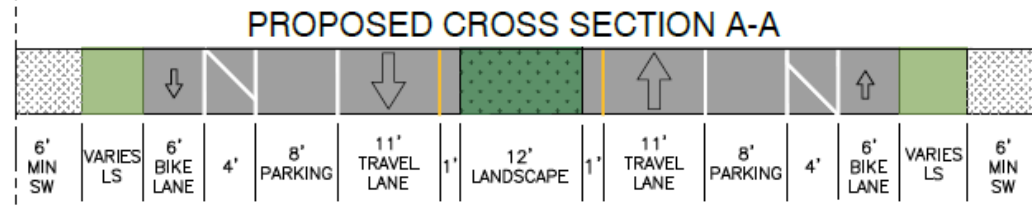

Segment C, Alternative 1: Road Diet and Parking Protected Bikeway

Existing: Between 7th and 8th St



Alternative 1: Between 7th and 8th St



EXISTING CROSS SECTION A-A

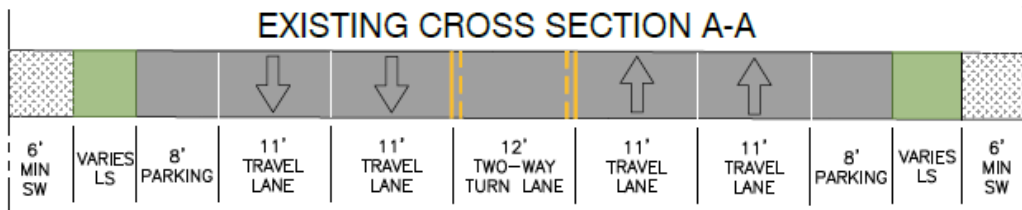

PROPOSED CROSS SECTION A-A

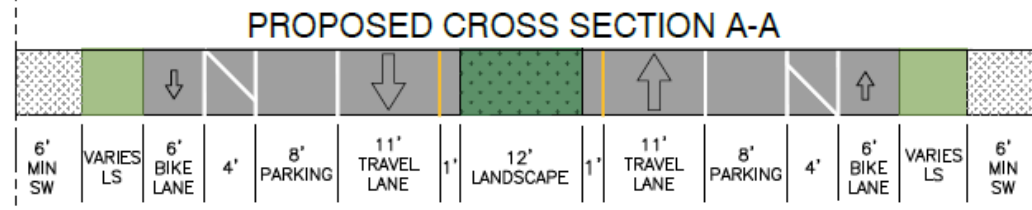

Segment C, Alternative 2: Separated Bikeway on a Four Lane Corridor

ALTERNATIVE 2 SHOWN BELOW

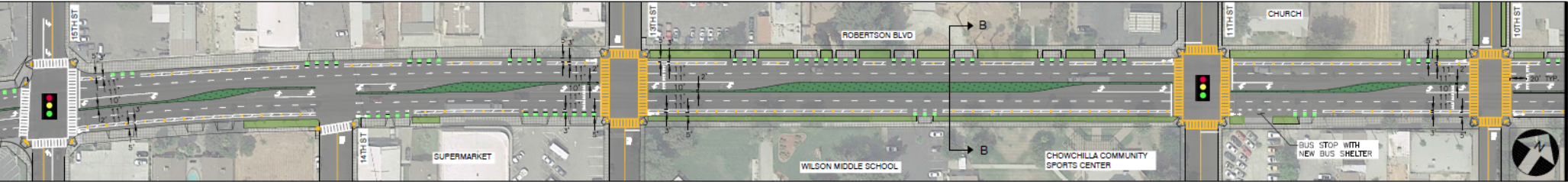

ALTERNATIVE 2 SHOWN BELOW

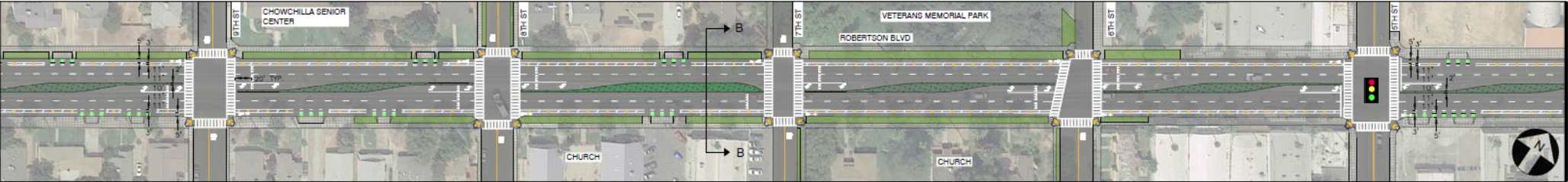

ALTERNATIVE 2 SHOWN BELOW

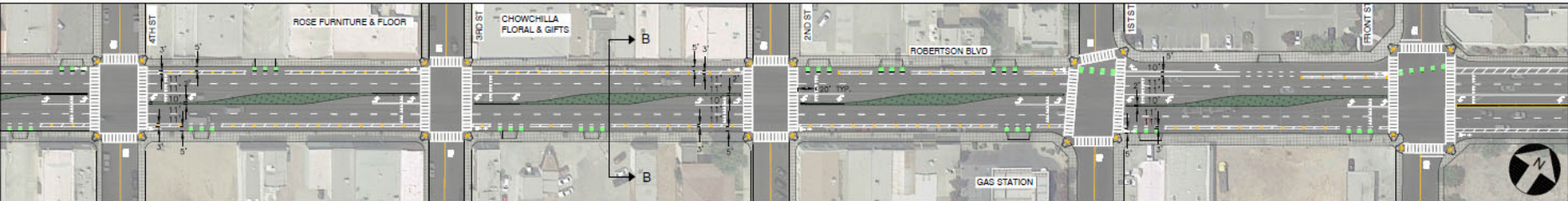

Segment C, Alternative 2: Separated Bikeway on a Four Lane Corridor

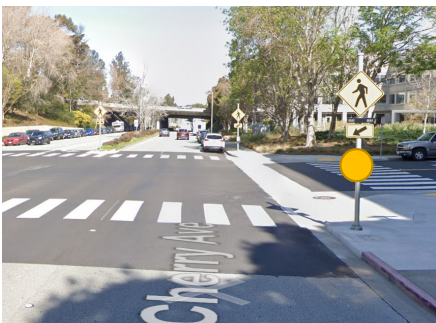
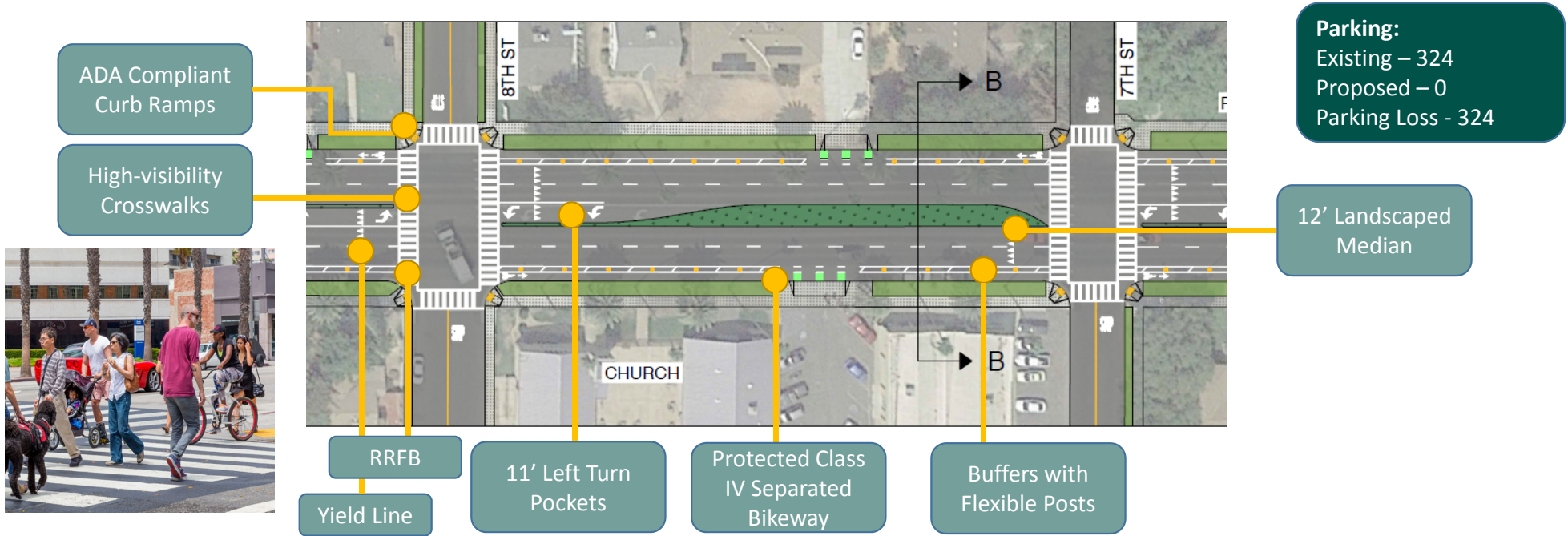

Segment C, Alternative 2: Separated Bikeway on a Four Lane Corridor

Existing: Between 7th and 8th St



Alternative 2: Between 7th and 8th St



EXISTING CROSS SECTION B-B

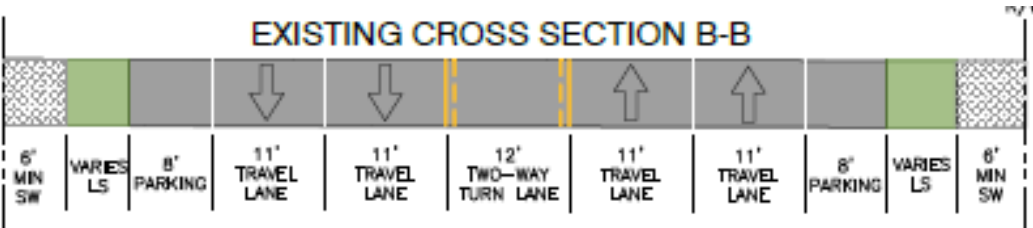

PROPOSED CROSS SECTION B-B

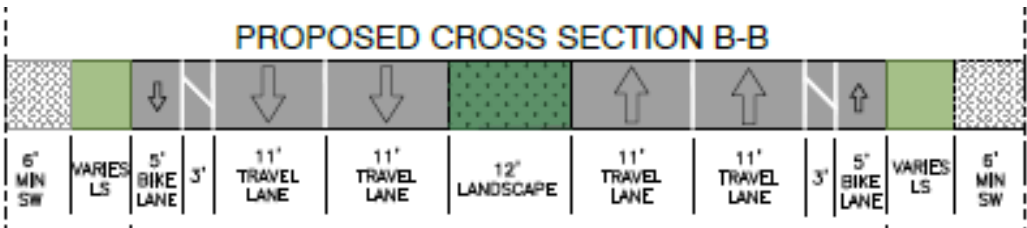

Alternative 3: Class II Bikeways and Bulbouts

ALTERNATIVE 3 SHOWN BELOW

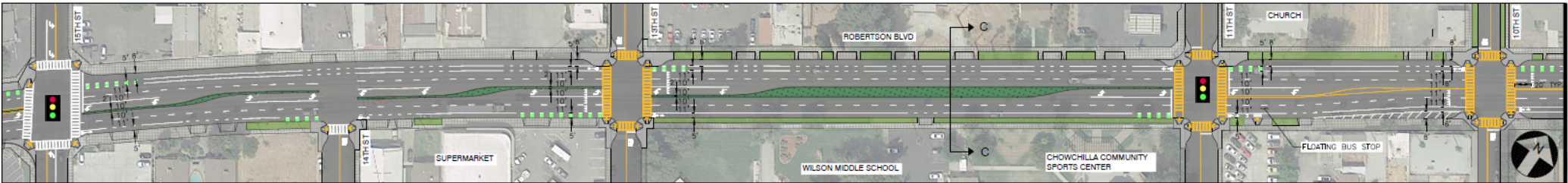

ALTERNATIVE 3 SHOWN BELOW

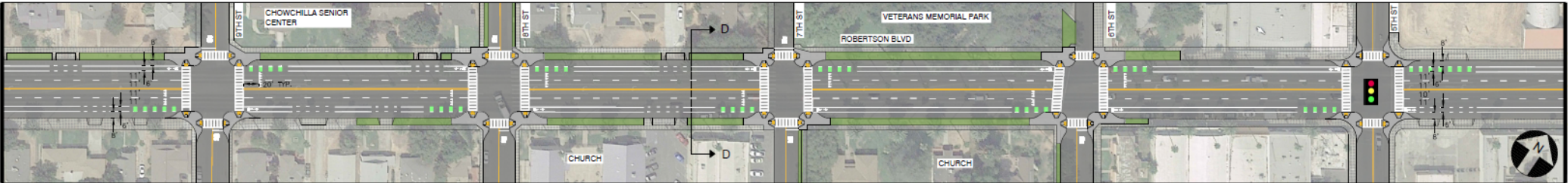

ALTERNATIVE 3 SHOWN BELOW

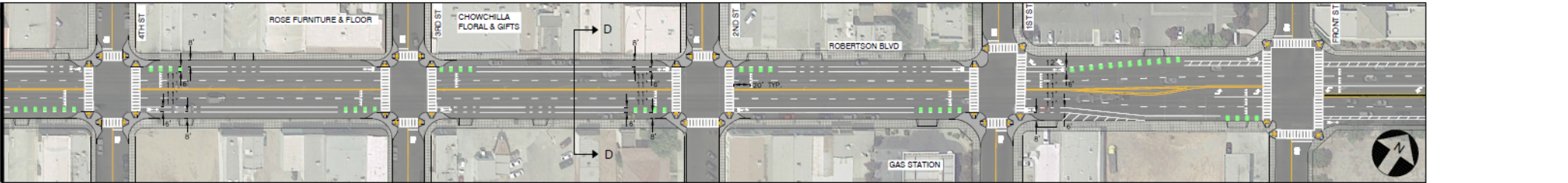

Segment C, Alternative 3: Class II Bikeways and Bulbouts

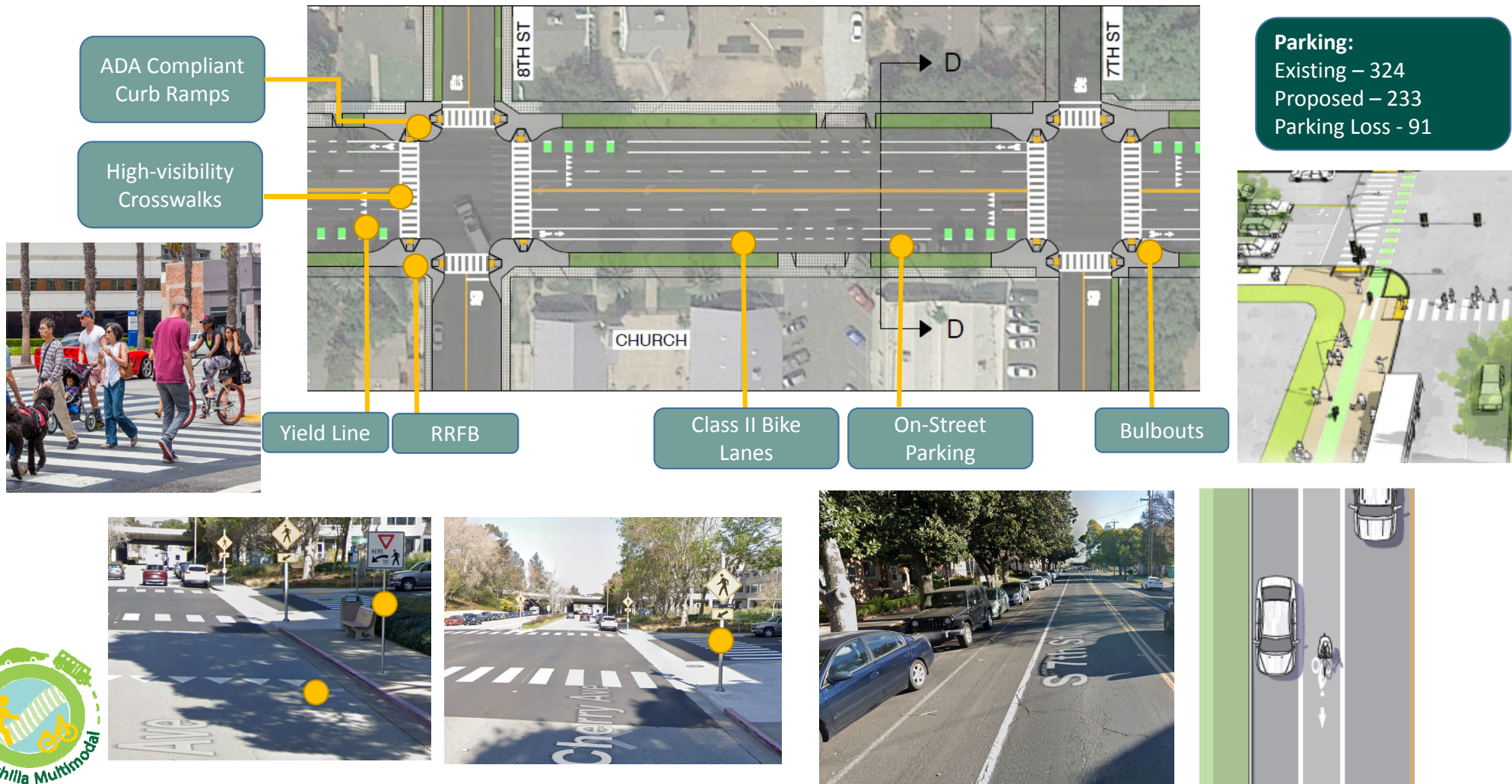

Segment C, Alternative 3: Class II Bikeways and Bulbouts

Existing: Between 7th and 8th St



Alternative 3: Between 7th and 8th St



EXISTING CROSS SECTION D-D

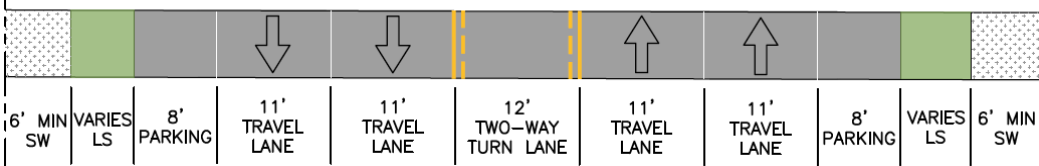

PROPOSED CROSS SECTION D-D

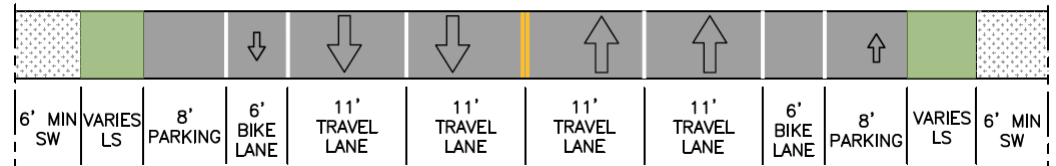

Segment A: SR 152 Highway Connector

- Class IV bike lanes
 - Buffers with flexible posts
- Shoulder lanes are eliminated
- ADA compliant curb ramps



Segment A: SR 152 Highway Connector

ALTERNATIVE 1 SHOWN BELOW

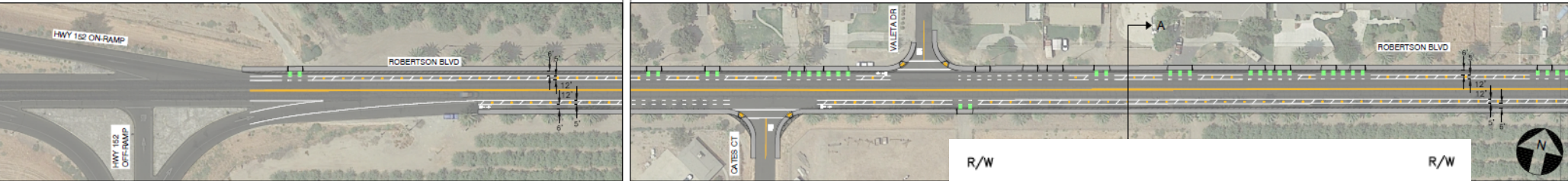

ALTERNATIVE 1 SHOWN BELOW

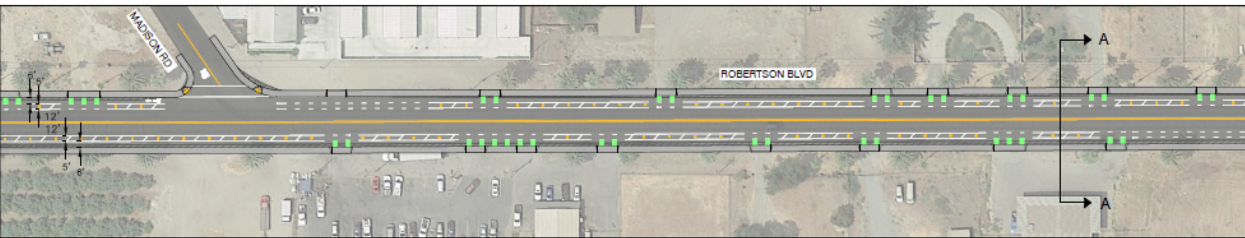

ALTERNATIVE 1 SHOWN BELOW

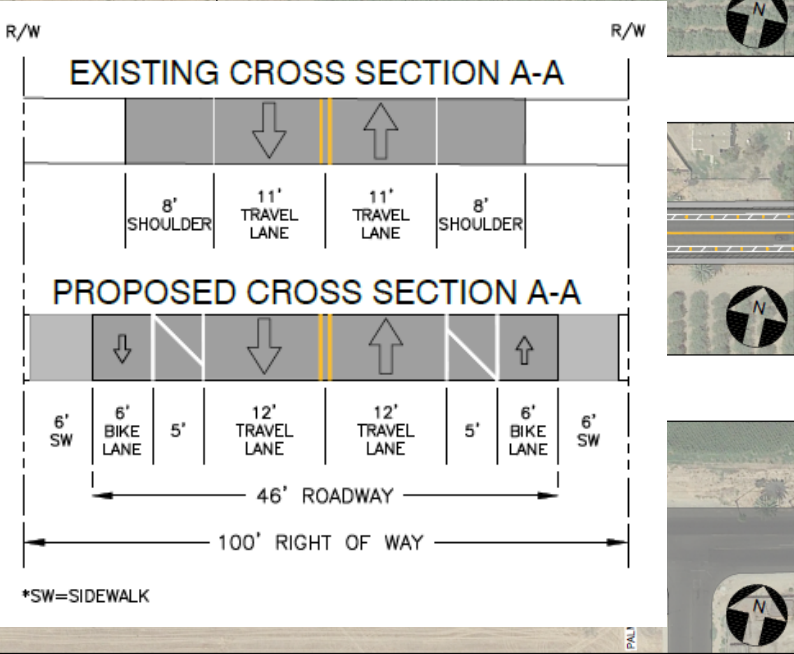
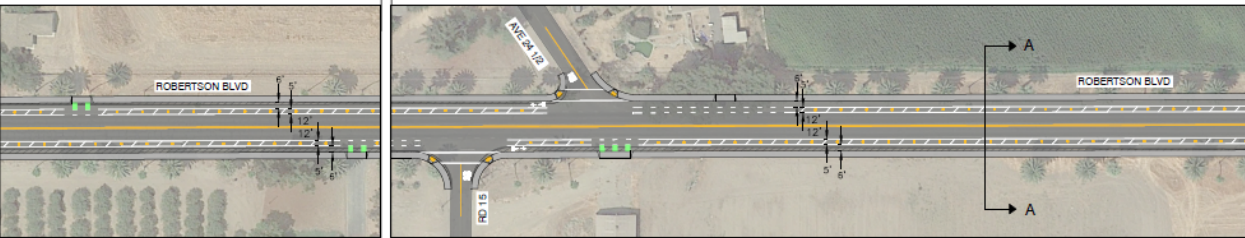

- Road Diet – 4 Lanes to 2 Lanes
- Landscaped median
- Class IV bike lanes
 - Buffers with flexible posts
- ADA compliant curb ramps



Segment B: Highway Connector to Urban Boulevard

ALTERNATIVE 1 SHOWN BELOW

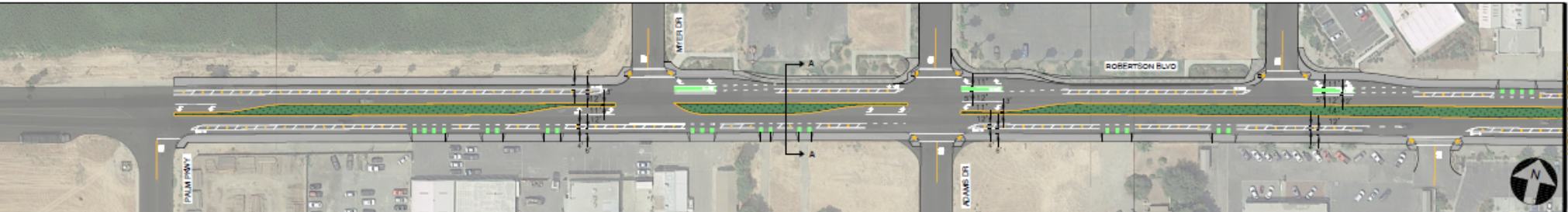

ALTERNATIVE 1 SHOWN BELOW

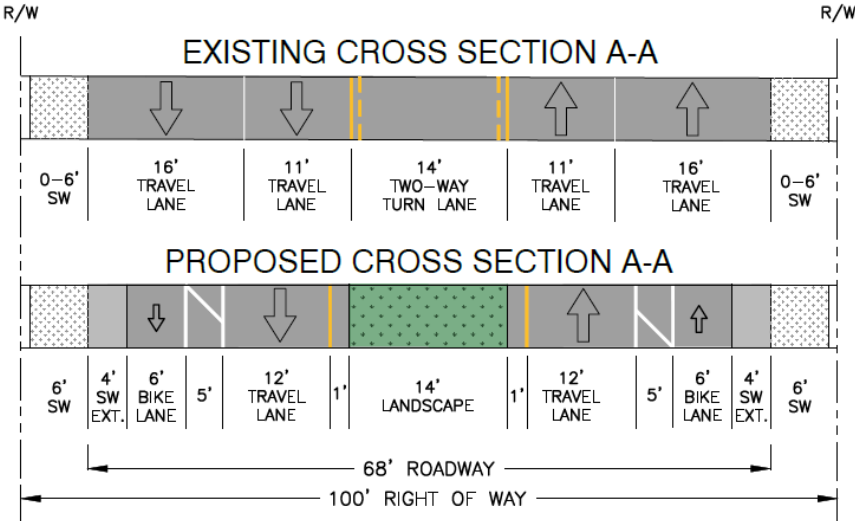
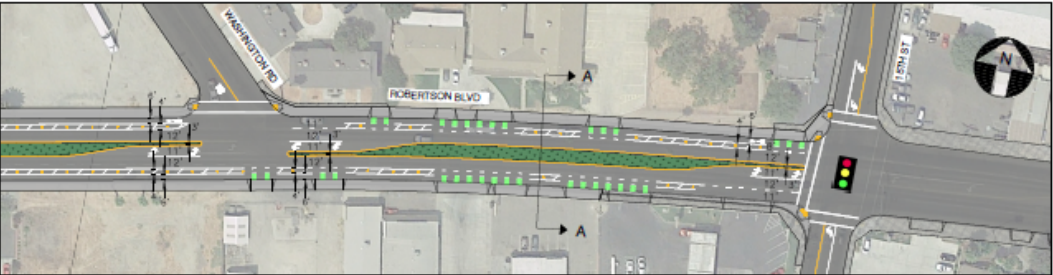

*SW=SIDEWALK
**EXT.=EXTENSION

Segment D: SR 99 Connector Ramps

- Convert existing shoulder to bike lane
- Install Class III Sharrow
 - Pavement markings at overpass
- ADA compliant curb ramps



Segment D: SR 99 Connector Ramps

ALTERNATIVE 1 SHOWN BELOW



ALTERNATIVE 1 SHOWN BELOW



R/W

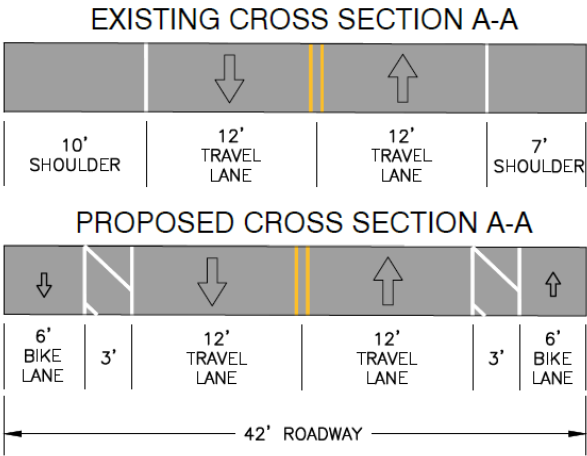

R/W

Segment E: Suburban Street

- Center turn lane with raised median landscape
- Class IV bike lanes
 - Buffers with flexible posts
- Sidewalk Improvements



Segment E: Suburban Street

ALTERNATIVE 1 SHOWN BELOW

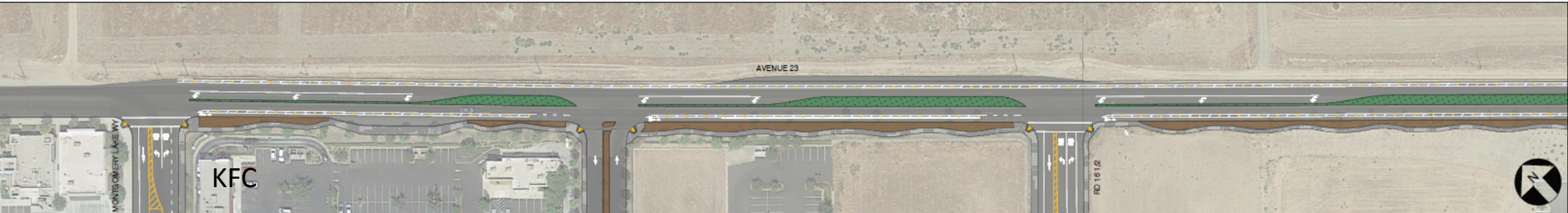

ALTERNATIVE 1 SHOWN BELOW

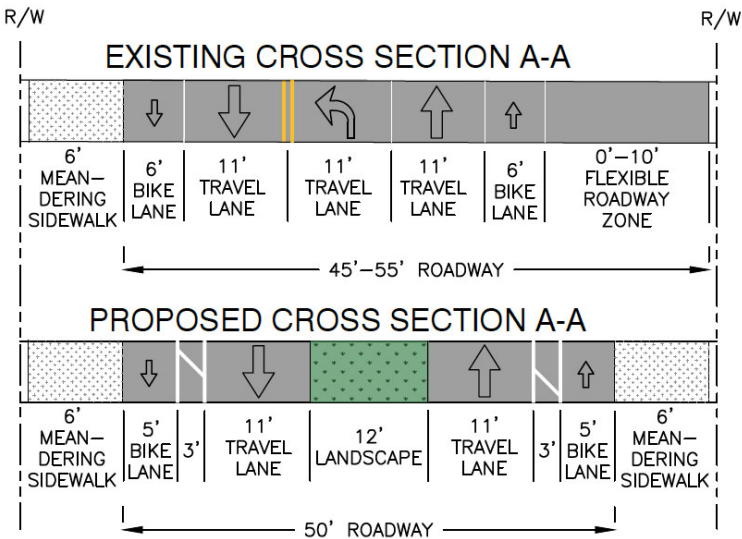

Segment F: Suburban Street to Rural Highway

- Class II bike lanes with buffer
- ADA compliant curb ramps



ALTERNATIVE 1 SHOWN BELOW

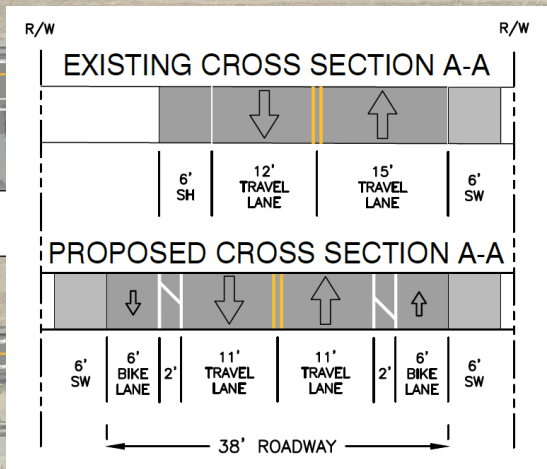

- Class IV bike lanes
 - Buffers with flexible posts
- ADA compliant curb ramps

- Class IV bike lanes
 - Buffers with flexible posts
- ADA compliant curb ramps



Segment G: Rural Highway

ALTERNATIVE 1 SHOWN BELOW

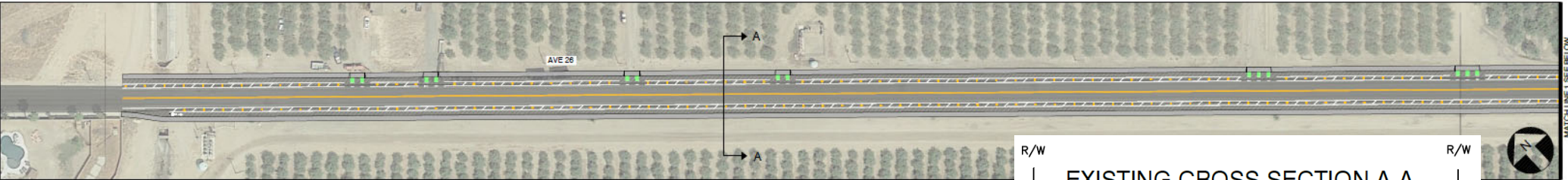

ALTERNATIVE 1 SHOWN BELOW



ALTERNATIVE 1 SHOWN BELOW

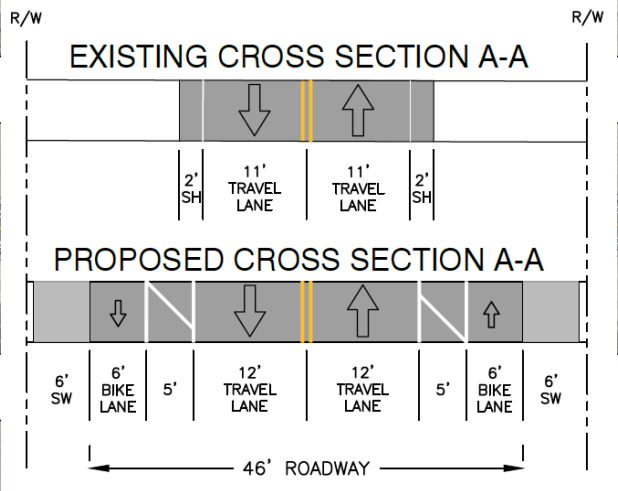
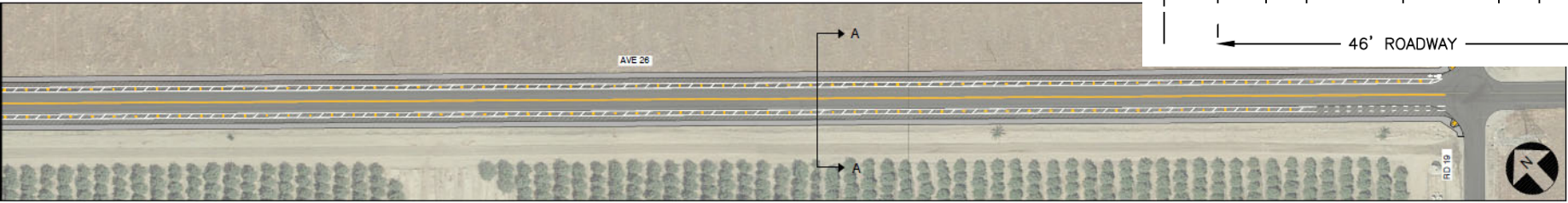

Comments and Questions?



Next Steps

- Community Workshop II
- Update Corridor Concept Design
- SR-233/Robertson Boulevard Corridor Planning Study – Draft Report

**Next Community
Workshop – July
2020**

